

APPROXIMATE PEDAL RATIO RANGE FROM [ 4.8 : 1 ] TO [ 6.1 : 1 ] DEPENDING ON FOOT PAD POSITION

DIE-CUT ANTI-SLIP TAPE SUPPLIED WITH KIT BUT NOT INSTALLED, GIVING CHOICE OF SMOOTH OR ROUGH PAD SURFACES.

OPTIONAL 72-183 SIDE EXTENSION FOR PULL THROTTLE CABLE 3.42 [87] SOLD SEPARATELY CUT TO LENGTH DESIRED

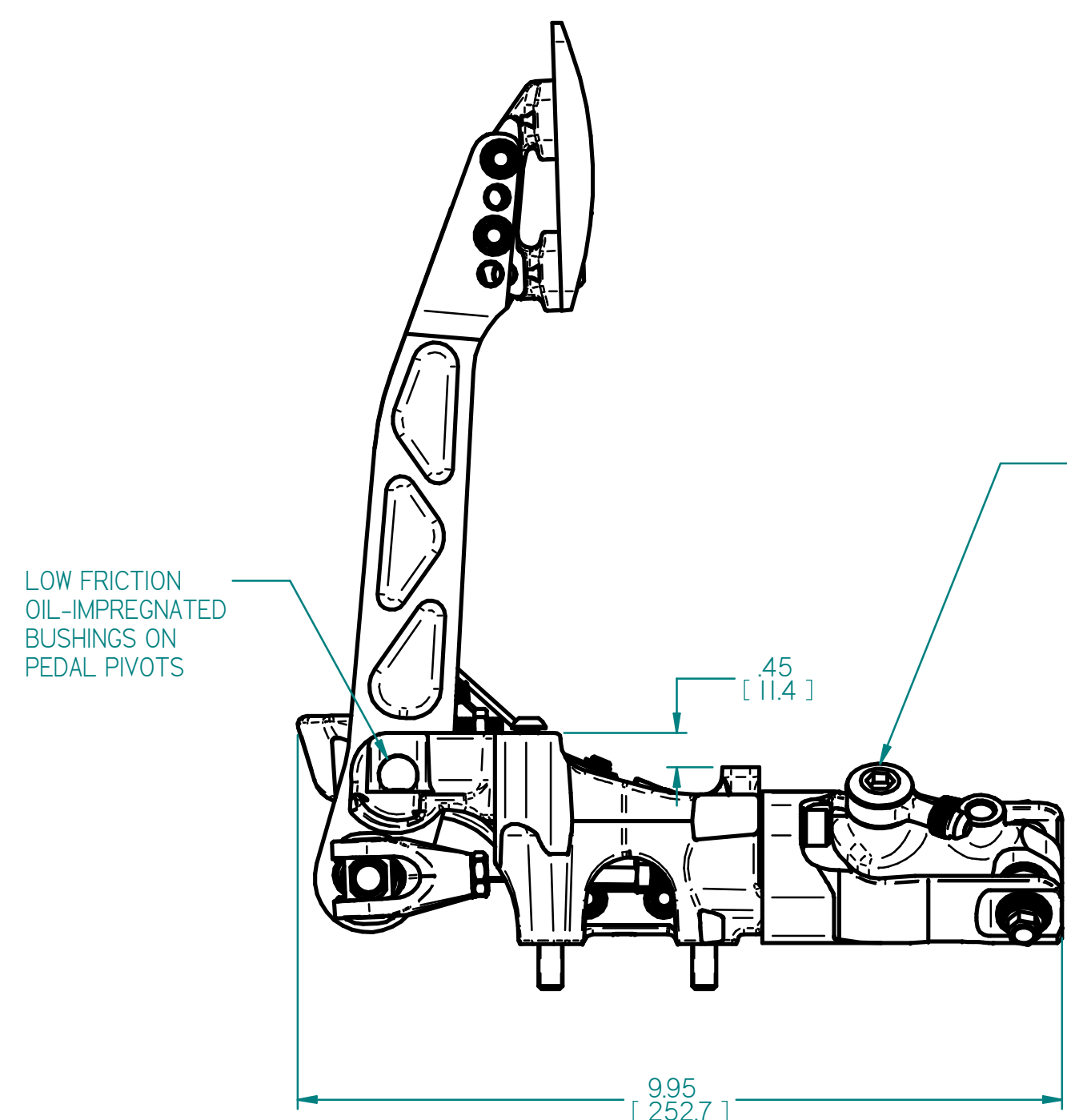
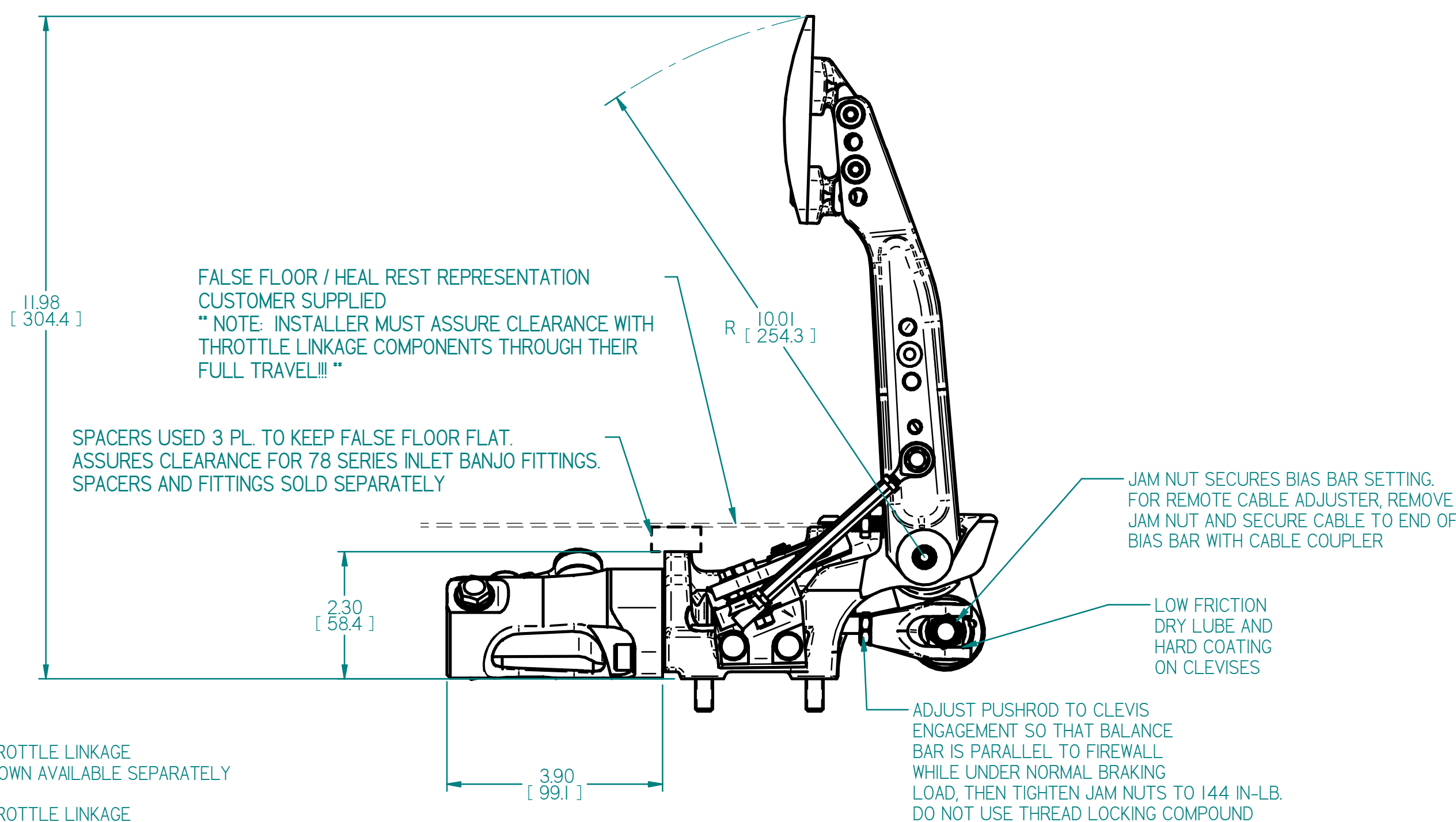
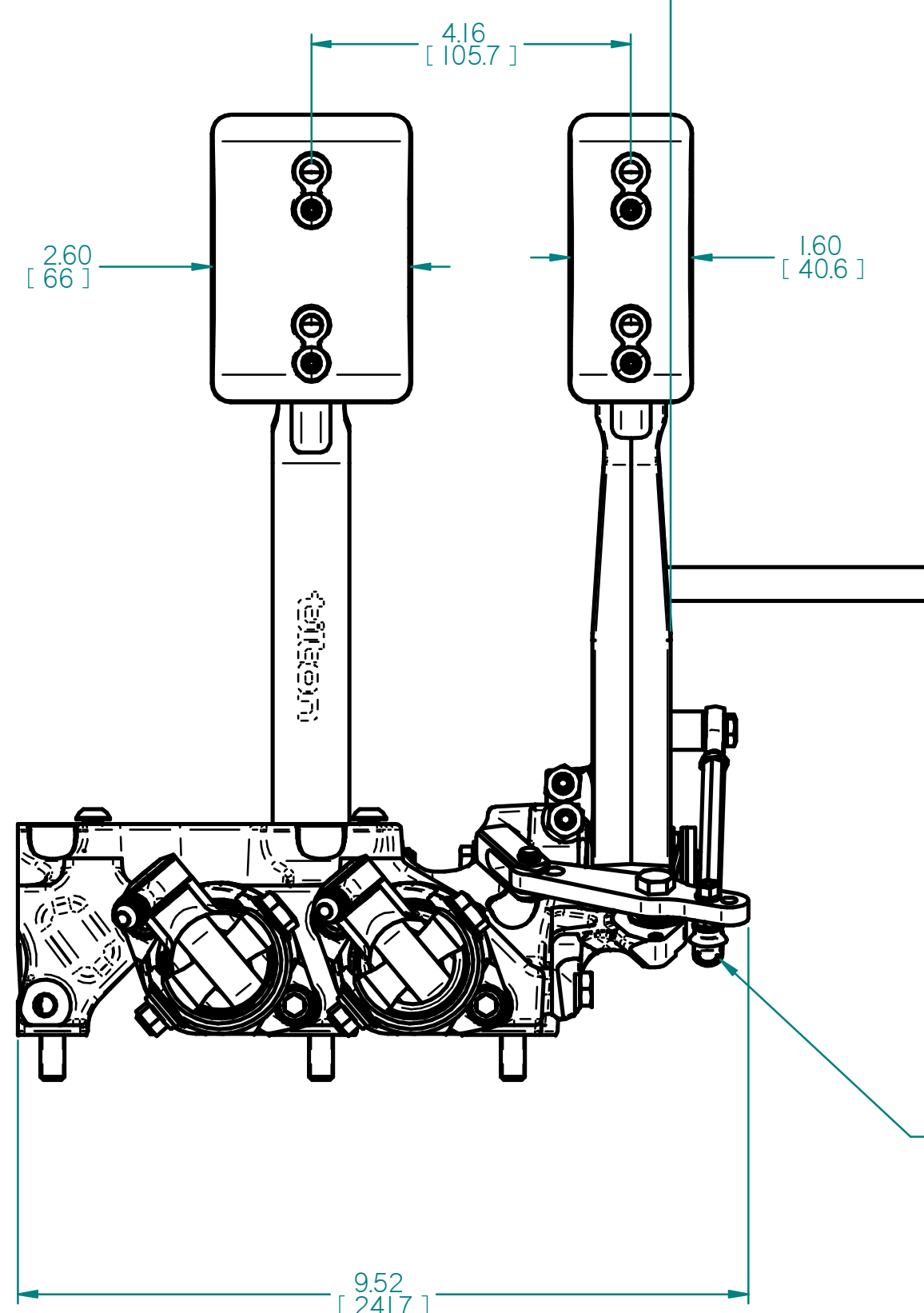

PEDAL ASSEMBLY IS COMPATIBLE WITH TILTON ENGINEERING 78 SERIES MASTER CYLINDERS AT BOTH BRAKE PEDAL LOCATIONS SOLD SEPARATELY

78 SERIES MASTER CYLINDERS SHOWN HERE ARE FOR ILLUSTRATION PURPOSES ONLY AND ARE NOT INCLUDED WITH PEDAL ASSEMBLY

- NOTES:
1. DIMENSIONS AND TOLERANCES PER ASME Y14.5 - 2009
  2. UNLESS OTHERWISE SPECIFIED, ALL DIMENSIONS ARE IN INCHES.
  3. DIMENSIONS ARE NOMINAL.

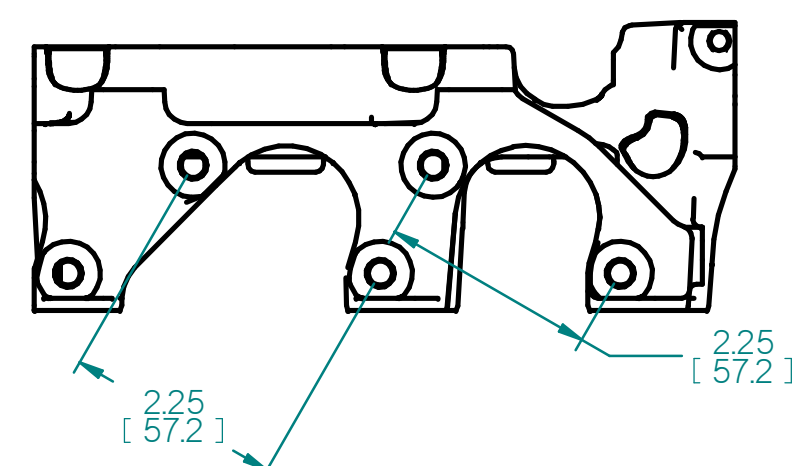

BRACKET CONNECTION REQUIRES 2 BOLTS. USE WIDEST SPREAD AVAILABLE PER PAD ANGLE DESIRED. 1.0" BOLT SPREAD MINIMUM

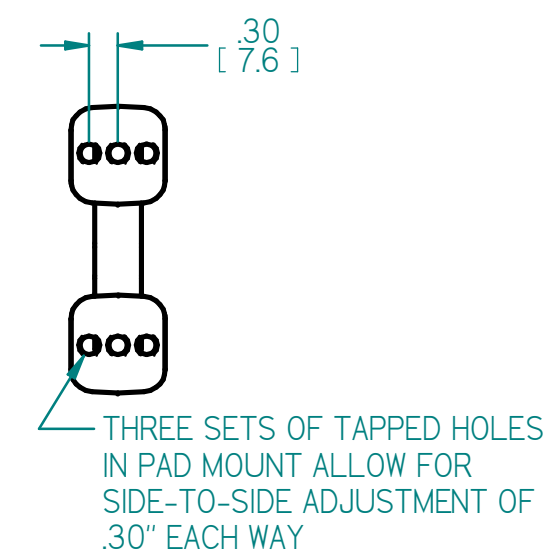
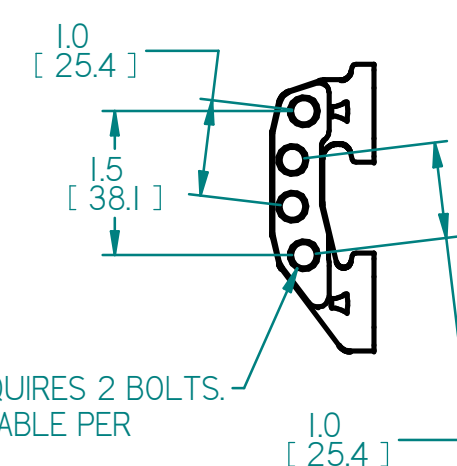

TILTON ENGINEERING, INC.		(805) 688-2353 FAX (805) 688-2745	
25 EASY STREET P.O. BOX 1787 BUELLTON, CALIFORNIA 93427 USA			
TITLE: <b>PEDAL ASSEMBLY, UNDERFOOT, 2 PEDAL, PIVOT TYPE MASTERS THROTTLE AND BRAKE PEDALS</b>			
DRN BY LUND	CHKD WAHL	SCALE 1:2	DWG 6526
P/N 72-818	DATE 6/25/2014	SHEET 1 OF 1	REV NC

This document contains proprietary information of TILTON ENGINEERING, INC., and its receipt or possession does not convey the rights to reproduce, disclose its contents, or to manufacture, use or sell anything it may describe. Reproduction, disclosure, or use without specific written authorization of TILTON ENGINEERING, INC. is strictly forbidden.

**TILTON ENGINEERING**