

PLUMBING MUST BE FLEXIBLE LINES AT INLET AND OUTLET OF PIVOT TYPE MASTER CYLINDERS. MASTER CYLINDERS MUST BE ALLOWED TO MOVE SLIGHTLY DURING ADJUSTMENT AND USE.

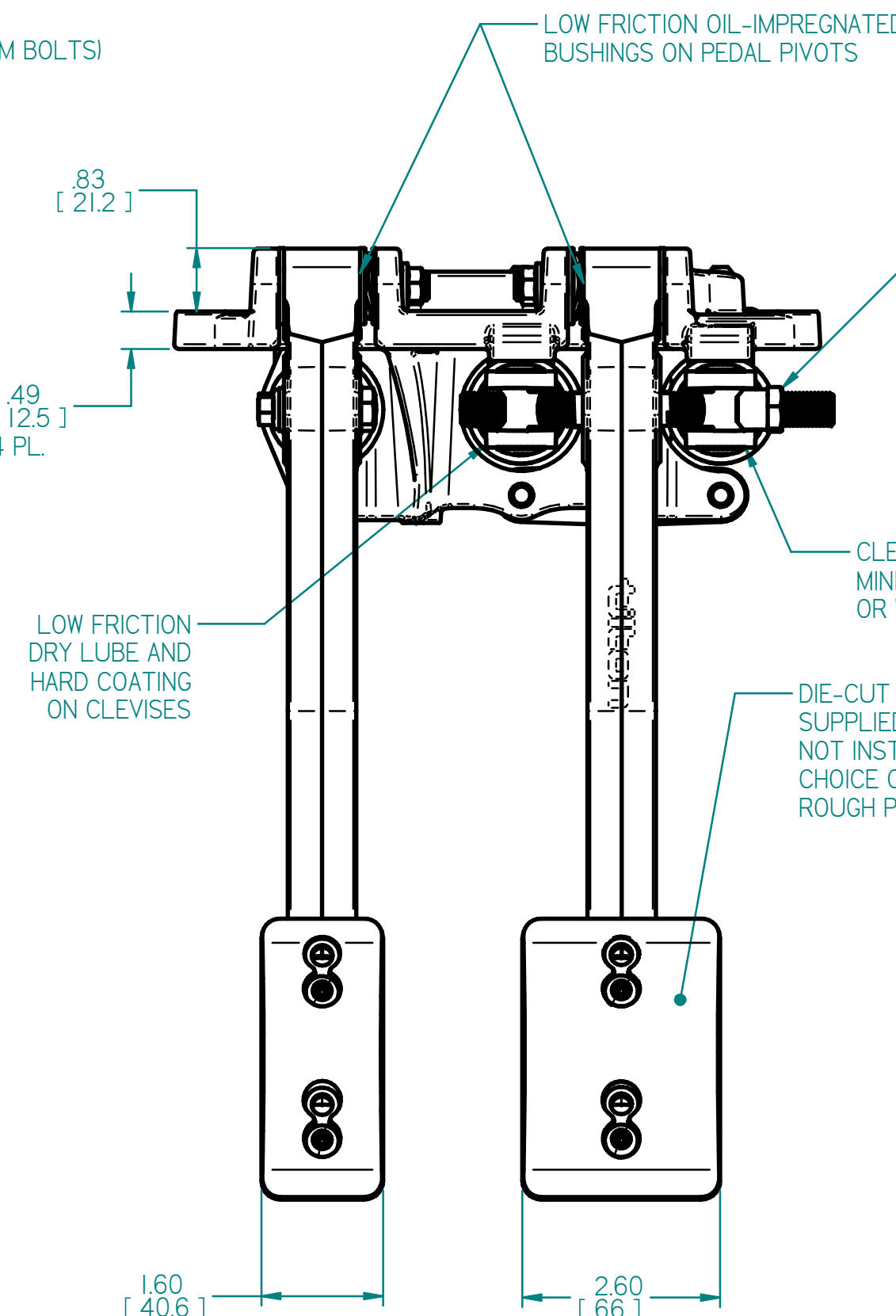

PEDAL RATIO WILL VARY FROM 5.0:1 TO 6.2:1 BASED ON PEDAL PAD POSITION.

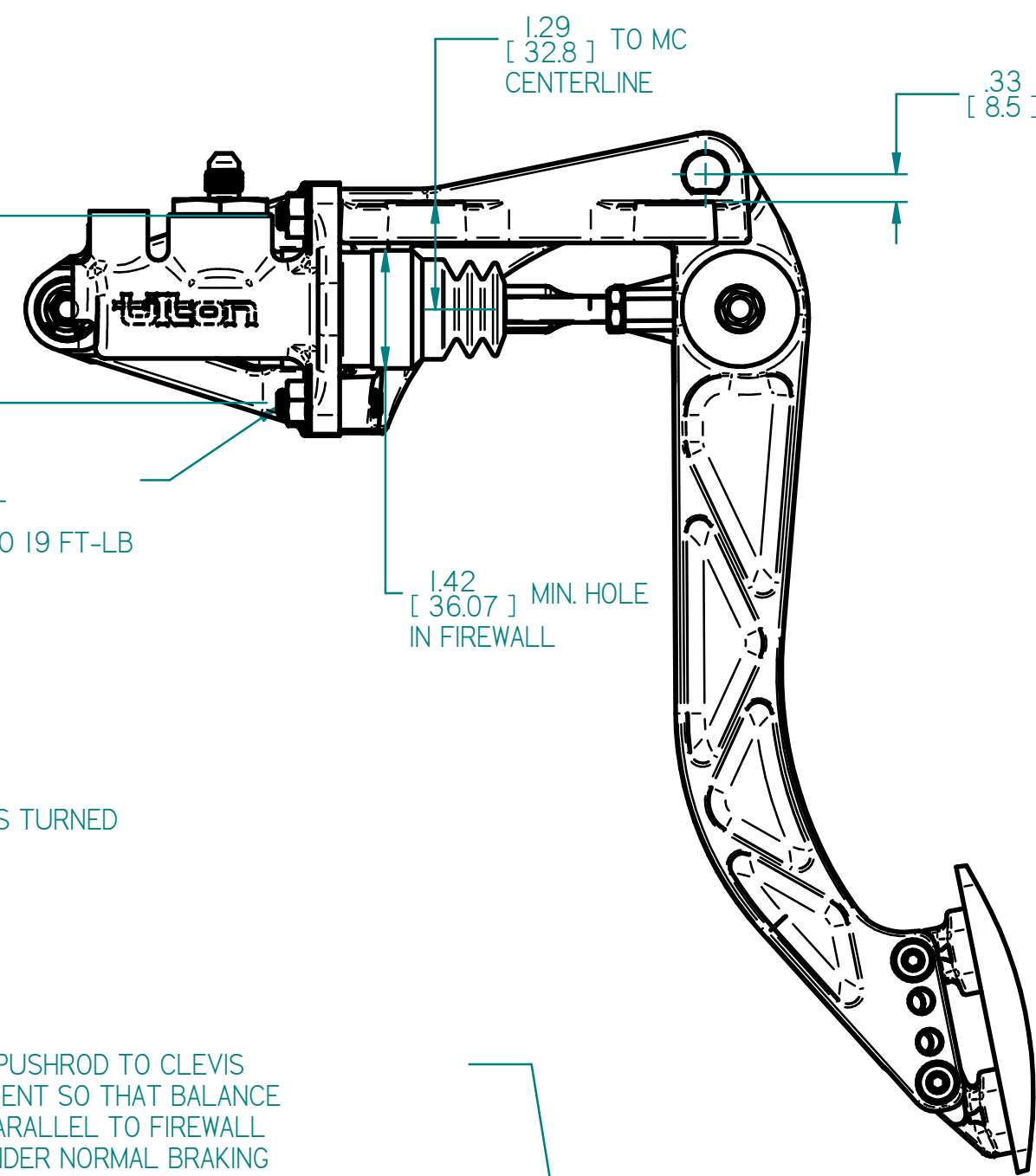
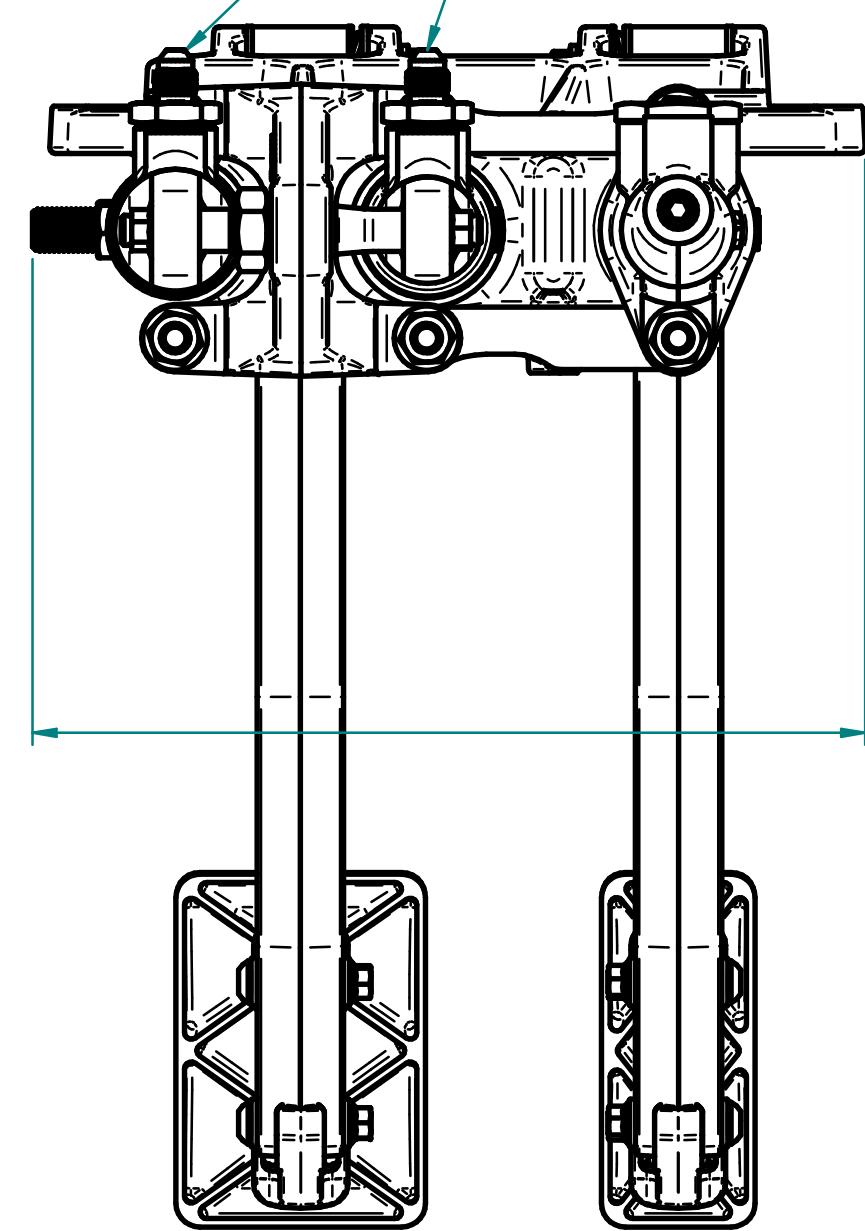
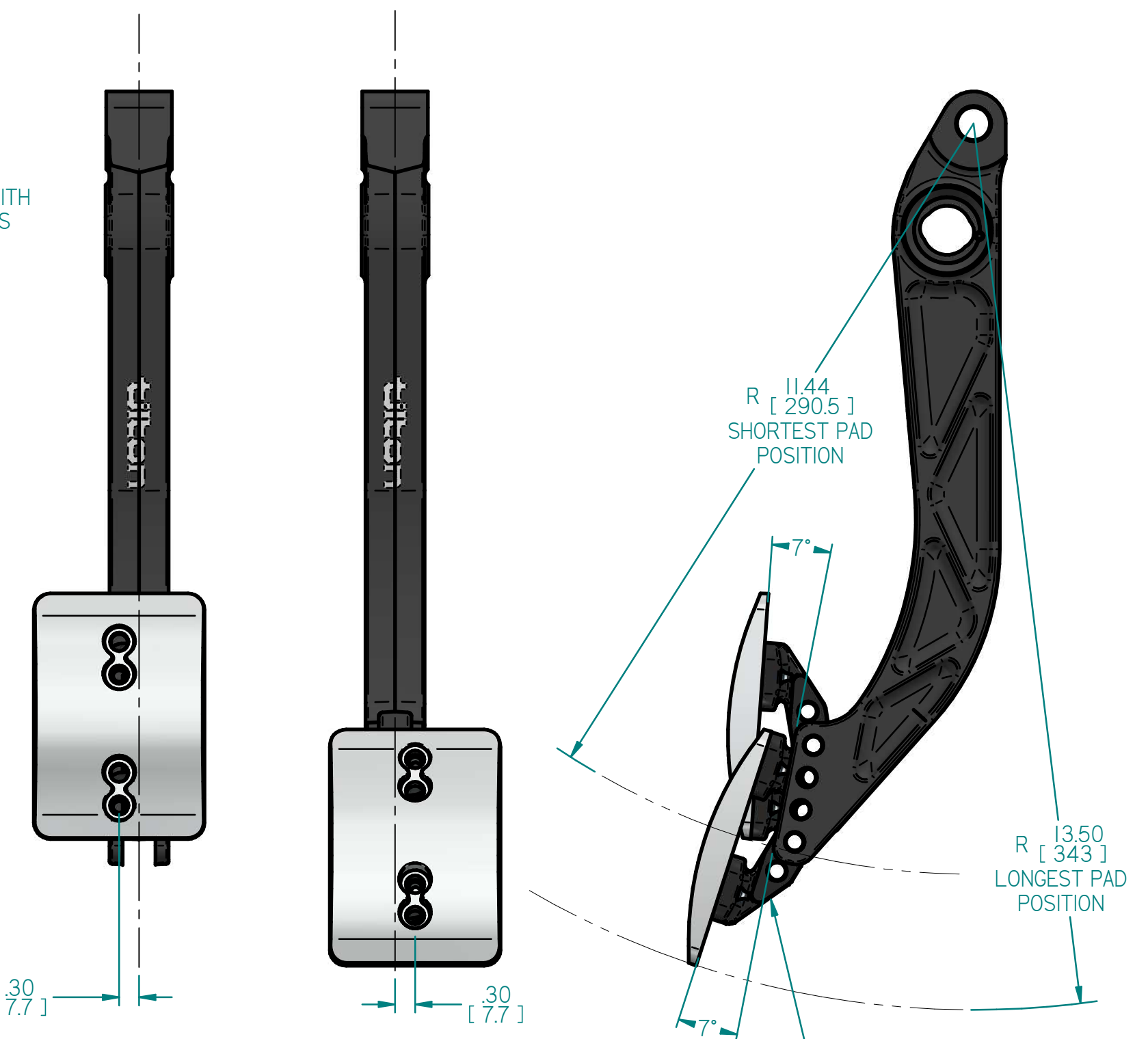

ADJUST PUSHROD TO CLEVIS ENGAGEMENT SO THAT BALANCE BAR IS PARALLEL TO FIREWALL WHILE UNDER NORMAL BRAKING LOAD, THEN TIGHTEN JAM NUTS TO 144 IN-LB. DO NOT USE THREAD LOCKING COMPOUND.

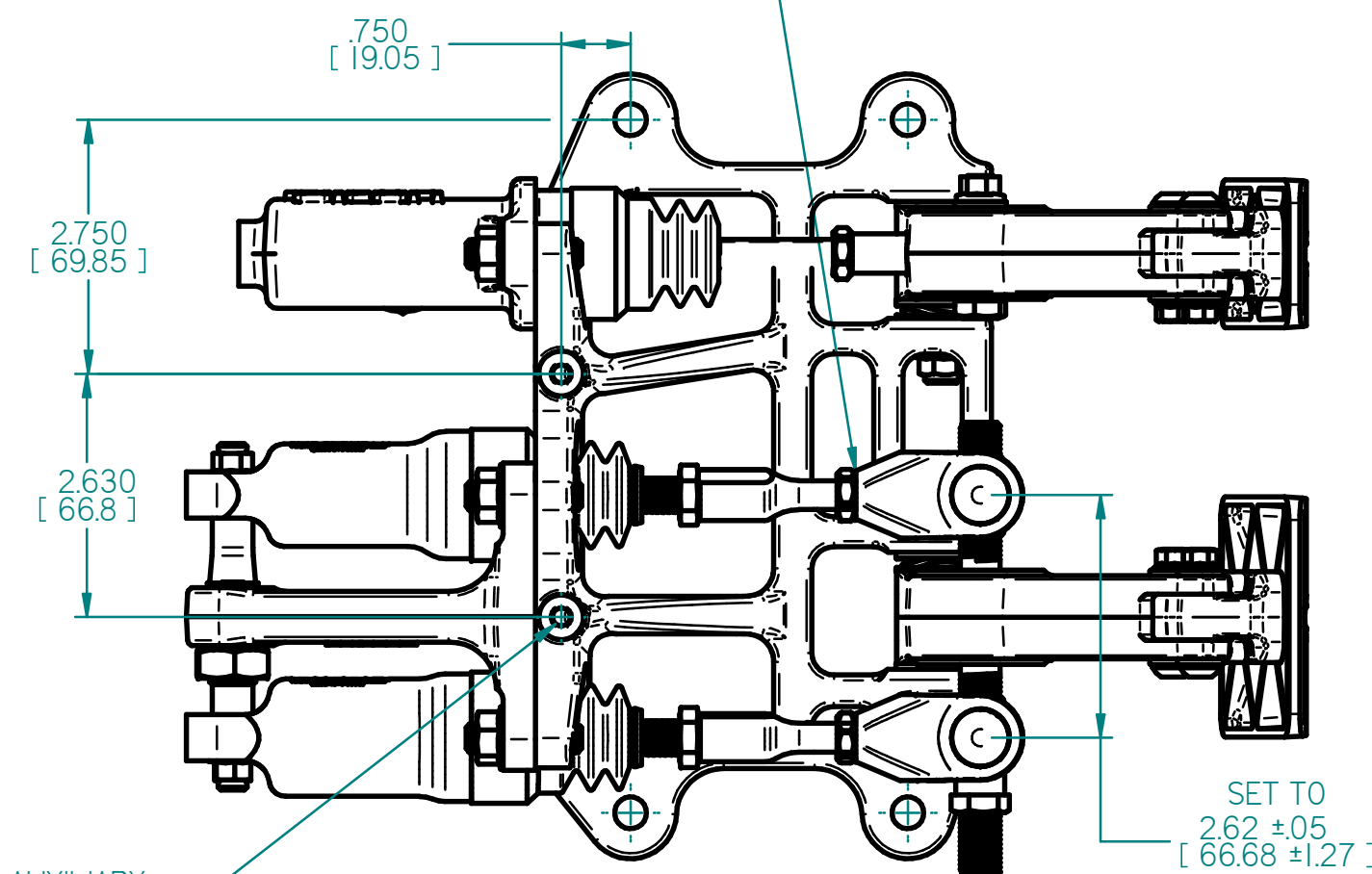

FOR CLUTCH, DO NOT EXCEED 3 DEGREES OF PUSHROD ANGULARITY DURING STROKE OF PEDALS. PREMATURE MASTER CYLINDER WEAR MAY OCCUR.

BRACKET CONNECTION REQUIRES 2 BOLTS. USE WIDEST SPREAD AVAILABLE PER PAD ANGLE DESIRED. 1.0" BOLT SPREAD MINIMUM

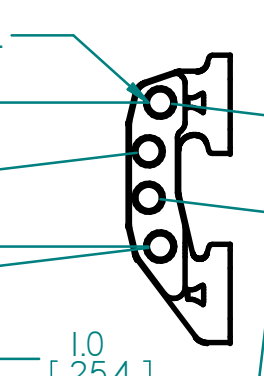

THREE SETS OF TAPPED HOLES IN PAD MOUNT ALLOW FOR SIDE-TO-SIDE ADJUSTMENT OF .30" EACH WAY

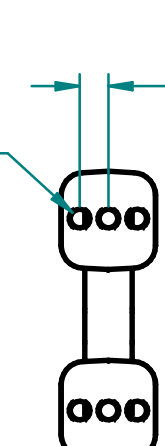

INTERMEDIATE PAD ADAPTER MOUNT ALLOWS FOR PAD VERTICAL ADJUSTMENT AND PAD ANGLE CHANGE.

- NOTES:
1. DIMENSIONS AND TOLERANCES PER ASME Y14.5 - 2009
  2. UNLESS OTHERWISE SPECIFIED, ALL DIMENSIONS ARE IN INCHES [MM].
  3. DIMENSIONS ARE NOMINAL.

PEDAL ASSEMBLY IS COMPATIBLE WITH TILTON ENGINEERING 73, 74, 75 OR 76 SERIES MASTER CYLINDERS AT THE CLUTCH PEDAL LOCATION AND ARE SOLD SEPARATELY

77, 78 SERIES MASTER CYLINDERS ARE TO BE USED AT THE BRAKE PEDAL LOCATION AND ARE SOLD SEPARATELY

76/78 SERIES MASTER CYLINDERS SHOWN HERE ARE FOR ILLUSTRATION PURPOSES ONLY AND ARE NOT INCLUDED WITH PEDAL ASSEMBLY

TILTON ENGINEERING, INC.		(805) 688-2353 FAX (805) 688-2745	
25 EASY STREET P.O. BOX 1787		BUELLTON, CALIFORNIA 93427 USA	
TITLE: <b>PEDAL ASSEMBLY, FIREWALL, PIVOT TYPE BRAKE MASTERS</b>			
INSTALLATION DRAWING, TWO PEDAL, THREE CYLINDER, FIREWALL MOUNT, ALUMINUM			
DRN BY LUND	CHKD WAHL	SCALE 1:2	DWG 6346
P/N 72-807	DATE 9/7/2016	SHEET 1 OF 1	REV NC

"This document contains proprietary information of TILTON ENGINEERING, INC., and its receipt or possession does not convey the rights to reproduce, disclose its contents, or to manufacture, use or sell anything it may describe. Reproduction, disclosure, or use without specific written authorization of TILTON ENGINEERING, INC. is strictly forbidden."

**TILTON ENGINEERING** INC.